

The Stressless® book  
of comfort

Global Collection 2016/2017



THE INNOVATORS OF COMFORT™



**EKORNES®**







Made in Norway  
since 1934



# The pleasure of comfort

Since 1934 we have had the pleasure of filling homes all around the world with comfort. Our longevity has helped to make Stressless® one of the best-known brands in the furniture industry. Our Ekornes colleagues all share a passion for detail and innovative solutions, this commitment enables us to continually invent new systems designed to give your body the best possible sitting experience – whilst giving your home the ultimate decor. Yes, we may be 80 years old, but we never stop pushing the boundaries and questioning the limits of what is possible in terms of ultimate comfort and the most spectacular designs.

There are many reasons why our recliners and sofas are so unbelievably comfortable – every piece of furniture is the work of highly-skilled staff, the effective choice of materials and innovative solutions. The landscape that surrounds us also plays a significant role in defining our products. Norway's majestic peaks and endless fjords set our minds at ease and are the perfect antidote to stressful days. If you have not yet visited the fjords but would like a taste of what they offer, we recommend taking a seat in a Stressless®. It may well be the closest you'll ever get to the bliss of pure comfort.





4/5

# The Stressless® book of comfort







## Introduction

This year, our many innovative solutions and options will ensure that you can sit or lie down more comfortably than ever.

But you shouldn't just take our word for it – try a Stressless® for yourself. We can't wait to show you our range of new products and timeless classics.



## 6-7

Three different bases - the choice is yours when selecting a recliner. Our range of options makes it easier than ever to find exactly what you are looking for.



## 22-23

Most of our Stressless® designs are available in three sizes, because all body types deserve the same exceptional comfort.



## 46-49

Many features help to ensure the unique comfort of our products – take a look at our full range of innovative solutions.



## 50-51

Our range includes a selection of tables and ottomans to further enhance your comfort experience.

# Contents

Stressless® Capri	6-7, 31, 52
Stressless® Como	30, 55
Stressless® Crown	33, 52
Stressless® E600	10-13, 56
Stressless® Garda	52, 59
Stressless® London	16-19, 54
Stressless® Live	9, 52
Stressless® Nordic	32, 53
Stressless® Panorama	21, 56
Stressless® Paris	14-15, 54
Stressless® Pause	24, 41, 55
Stressless® Peace	22, 53
Stressless® President	36, 53
Stressless® Viva	28, 53
Stressless® Wave	26, 40-43, 55
Stressless® Wing	29, 53
Ekornes® Manhattan	34, 56
Ekornes® Oslo	38, 56
Stressless® Design Online	18-19
Stressless® Home Cinema	40-43



Stressless® Office	44-45
Comfort test™	46-47
The unique Stressless® features	46-49
Tables and ottomans	50-51
Glossary	52-57
Leather and wood	58-59

# Our unique comfort your choice

All Stressless models offer the ultimate in comfort. So regardless of the base you choose you can be sure that you'll sit like a king or a queen. With so many unique options, you're guaranteed to satisfy all your requirements. Go ahead – it's your choice.



## **Signature base with BalanceAdapt™**

Soft, comfortable rocking movements from a wood and aluminium base. A delight for both the body and the eye. Available in sizes S, M and L.



## **Home Office base**

Full freedom of movement with full comfort – even at home. With our Home Office chairs, work becomes a pleasure. Available in size M.

## **Classic base**

With its unique stability and timeless design, this base has provided decades of exceptional comfort. Available in sizes S, M and L.





**STRESSLESS® PEACE**

S M L

---

**Stressless® Capri**  
recliners shown in  
Paloma Light Grey / Oak.







# Welcome. Take a seat.

---

We have always placed the utmost emphasis on making the highest standard of recliners but never before have we offered so many choices and options. You can now choose from three different bases, several sizes and a range of innovative solutions that will give you an exceptional comfort experience.



**STRESSLESS® LIVE**

**S M L**

**Stressless® Live (L) Classic** recliner shown in Cori Petrol/Wenge. **Stressless® Swing** table. Our complete range of models is shown on pages 50-57.



## Refreshingly comfortable

---

The Stressless® E600 is a simple classic design which can complete the look of any living room. With its multitude of colour options, large comfortable cushions, stylish legs, optional headrests and flexible modules, this is a sofa that can be used for any and every occasion.

Featuring the Stressless® ErgoAdapt™ system, the seat automatically angles in response to your body's movement – turning every situation into a chance to relax.







## STRESSLESS® E600

---

Stressless® E600 sofa is shown in fabric Noblesse Brown with Steel legs.  
Stressless® Style table.

Our complete range of models is shown on pages 50-57.









## STRESSLESS® E600

---

**Stressless® E600** sofa shown in Paloma Sparrow Blue with Steel legs.  
**Stressless® Urban Small** table.



The Stressless® Urban glass table comes in two different sizes; a practical small table and a larger option. The table has been designed to match our Stressless® Paris and Stressless® London recliners, but its classic good looks mean it works well with many of our Stressless® and Ekornes® sofas.

The built-in ErgoAdapt™ system on the Stressless® E600 allows you to sink into the soft cushion. This discreet tilting mechanism makes the sofa automatically adjust to your body, providing you with a perfect sitting angle or sleeping position.



Read more about **ErgoAdapt™** on page **49**.  
Our complete range of models is shown on pages **50-57**.





# Individual comfort

---

The slender, elegant shape of our Stressless® Paris recliner makes it perfect for a cosy get-together with friends, but is equally suitable if you are looking for a few minutes of calm by yourself. The combination of a stylish rotating base, fresh lines and a headrest pillow on the high back model ensures that all your comfort needs are met.



**STRESSLESS® PARIS**

---

▲ **Stressless® Paris** Low Back recliner shown in Paloma Metal Grey. **Stressless® Urban Small** table.  
◀ **Stressless® Paris** recliner shown in Cori Mustard.  
Our complete range of models is shown on pages **50-57**.







**STRESSLESS® LONDON**

---

- ◀ **Stressless® London** recliner shown in Paloma Henna. **Stressless® Flexi** table.
  - ▼ **Stressless® London** Low Back recliners shown in Cori Vanilla. **Stressless® Urban** large table.
- Our complete range of models is shown on pages 50-57.



## Comfort refined

---

Stressless® London demands attention, but has also been designed to adapt to its surroundings. This modern furnishing solution enables friends and family to spend time together in style. It comes in high back and low back models, and the matching footstool gives your feet some well-deserved comfort. After all, they deserve to be pampered every now and then too.

The Stressless® Flexi table is perfect for both working and kicking back. It is height adjustable and the glass tabletop can be easily tilted to transform it into a standing laptop table. Work at home in peaceful surroundings, embraced by the comfort only a genuine Stressless® can provide.



18/19

Designing your own living room does not get easier than this. With our newest online solution – Stressless® Design Online, dreaming doesn't cost a thing.



Stressless® London Low Back recliners shown in Cori Vanilla. Stressless® Urban large table.

# Stressless® Design Online

## IT'S EASY:

1. Log on to [www.ekornes.co.uk](http://www.ekornes.co.uk) and click on Stressless Design Online which can be found under tools at the bottom of the web page.
2. Choose your perfect Stressless® models in your preferred leather and wood colours.
3. Print your tailor-made design.
4. Take the print out to your local Stressless® retailer and make your dreams come true!



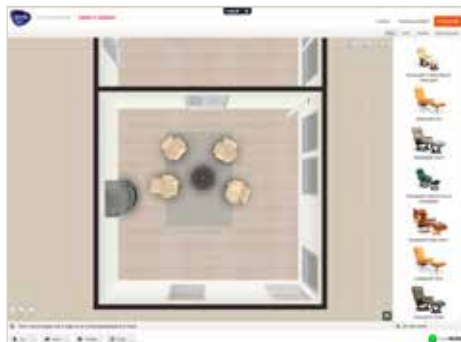
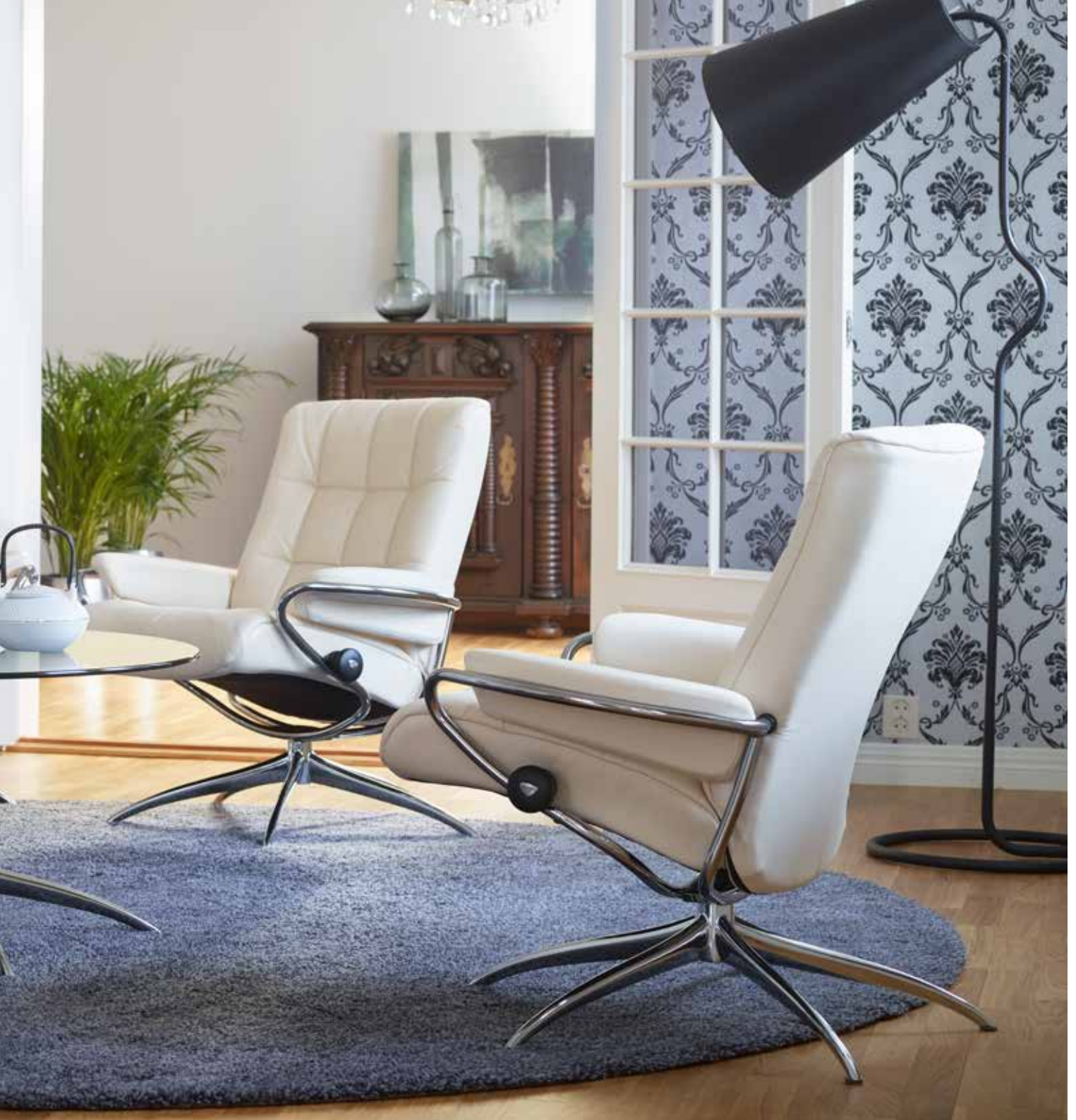





# Maximum comfort

---

The smallest of movements is often what makes the difference between a good sitting experience and a great one. With BalanceAdapt™ the sitting angle automatically adjusts to your body's tiniest movement. It's all about finding the right balance – from head to toe, without the use of levers or handles. The soft rocking motion increases your comfort in all positions.



## STRESSLESS® PANORAMA

---

**Stressless® Panorama** sofa shown in Paloma Olive. **Stressless® Enigma** table.



Read more about **BalanceAdapt™** on page 48.  
Our complete range of models is shown on pages 50-57.



22/23

## A perfect end to the day

---

When quiet has finally descended on your home you can curl up in your own individual Stressless® Peace. We understand that you want to spend a good deal of time in your Stressless® so with this in mind the quality of our recliners is of the utmost importance. Most of our Stressless® recliners are available in all sizes. And with features such as the Plus™ system, absolutely everyone can enjoy a movie or good conversation in comfort.

**Stressless® Peace (M) Signature** and **Stressless® Peace (L) Signature** recliners shown in Paloma Sparrow Blue / Walnut. **Stressless® Urban Small** table.





3 sizes  
– Same design



Read more about our base options on pages 6-7. Our complete range of models is shown on pages 50-57.



STRESSLESS® PEACE

S M L



24/25

## A corner of possibilities

---

Some of our sofas come in both high back and low back options with individually adjustable seats. Whether you prefer sitting up a little straighter or you love leaning back, the Plus™ system will provide optimal support for your neck and lower back. The Stressless® Pause comes in many different configurations, you can even create your own personal comfort corner to curl up in.







## STRESSLESS® PAUSE

**Stressless® Pause** sofa shown in Paloma Beige. **Stressless® Urbane Large** table.  
Our complete range of models is shown on pages 50-57.

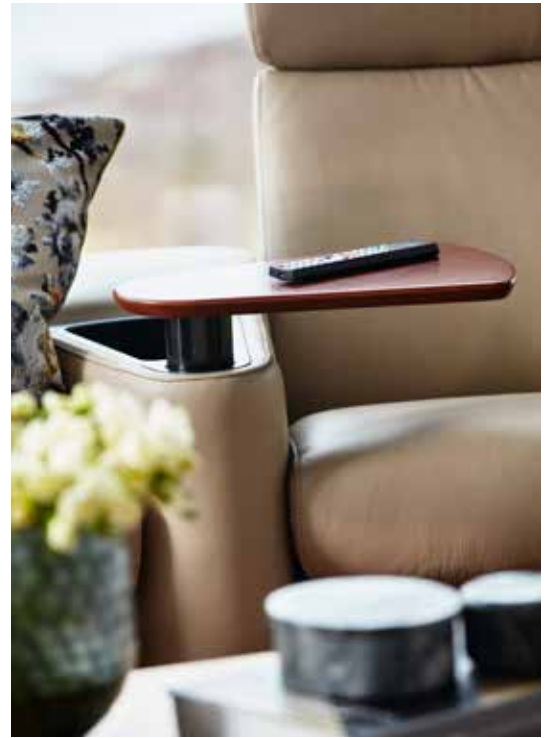

Within the sector arm unit is a practical storage space for remote controls.

The Stressless® Easy Armrest table fits onto the sofa's armrest, providing you with the perfect place to set your drink or snack.









Stressless® Wave sofa shown in Cori Vanilla. Stressless® Enigma table (centre).  
Stressless® Flexi table (on right). Our complete range of models is shown on pages 50-57.





# Comfort from the bottom up

---

Most Stressless® recliners are now available with our Signature base, which combines beautifully shaped beech and sleek aluminum. To give you the ultimate choice; it is available in seven different wood finishes.

With BalanceAdapt™ elegantly integrated into the base, the recliner's soft, comfortable rocking movements will ensure true comfort – from the bottom up!



**Stressless® Wing (M) Signature** recliner shown in Paloma Black / Wenge.  
**Stressless® Urban Small** table.



**STRESSLESS® VIVA / STRESSLESS® WING**

**S M L**

**Stressless® Viva (L) Signature** recliner  
shown in Paloma Indigo / Wenge.

---

Read more about our base options on pages **6-7**.  
Our complete range of models is shown on pages **50-57**.



30/31

STRESSLESS® COMO



STRESSLESS® CAPRI S M L



**Stressless® Como** sofa and **Stressless® Capri (L) Classic** recliner shown in Batick Grey/Wenge.  
Read more about our base options on pages 6-7.  
Our complete range of models is shown on pages 50-57.





# When comfort is at stake

---

Follow up a great dinner with a little friendly competition! The winner gets to stretch out on the sofa, while the loser clears the table and does the dishes. Stressless® Como comes as both high and low back sofas and can sit as a generous corner group when paired with a big corner piece. Featuring a height adjustable headrest; now you will both sit comfortably. May the best man or woman win!





**Stressless® Nordic (M) Classic** and **Stressless® Nordic (L) Classic** recliners shown in **Batick Cream / Wenge**. **Ekornes® Corner table**.  
Read more about our base options on pages 6-7. Our complete range of models is shown on pages 50-57.





STRESSLESS® NORDIC / STRESSLESS® CROWN

S M L

## The comfort of your choosing

Most of our Stressless® designs are available in two or three sizes. Stressless® gives you the choice as we want everyone to have the opportunity to experience a bespoke comfort feeling, regardless of body shape and size. If you want it – it's yours!



**Stressless® Crown (L) Classic** recliner shown in Cori Beige / Wenge.  
**Stressless® Swing** table.

The Stressless® Swing table heightens the comfort of your Stressless® recliner. This small, versatile table provides a practical place to set your remote control, book or whatever else you like to keep to hand. It fits most recliners with our famous round Classic base.



## Classic and elegant

---

Ekornes® Manhattan combines delicate leather with elegant woodwork, enabling you to optimise the classic, exclusive look of your living room. Why not sit by the fireside, or relax with a glass of something good? We've given you our suggestion – the rest is up to you.

**Ekornes® Manhattan** sofa shown in Paloma Aqua Green / Wenge. Our complete range of models is shown on pages **50-57**.













## Clever comfort

---

We continuously strive to find new, innovative ways of enhancing your comfort. Our numerous integrated table solutions are tailor-made for your most comfortable sitting position, without compromising the overall look and feel of your Stressless® recliner.

The Stressless® Computer table provides a firm, stable workspace. Positioned directly above your lap, it enables you to enjoy all the ergonomic advantages of your favourite recliner while using your laptop. When you're done working or browsing the Internet, simply swing the table aside and fold it down alongside the recliner.



Stressless® Computer table.



**STRESSLESS® PRESIDENT**

**S M L**

---

**Stressless® President (M) Signature** and **Stressless® President (L) Signature** recliners shown in Paloma Copper / Wenge.  
**Stressless® Urban Small** table.

Read more about our base options on pages **6-7**.  
Our complete range of models is shown on pages **50-57**.





## Comfort at the core

---

Ekornes® Oslo is a classic sofa that is available with visible woodwork or a fully upholstered front. Its warm and soft shapes and timeless design are completely focused on ensuring your comfort. Regardless of how you choose to sit or recline, you'll discover how we put comfort at the core.







40/41

Stressless® Wave SC 121 shown in Paloma Summer Green / Black.  
Stressless® Double ottoman.





# Movie bonanza

---

You move more than 300 times during the length of a movie. This might sound exhausting, but don't despair – Stressless® seating is designed to adjust to your every movement. The spacious, soft seats of your Stressless® Home Cinema seating, combined with a Stressless® ottoman, ensure an optimal movie experience.

Regardless of how much space you have available for your home cinema setup, our ingenious flexible modular designs ensure that there's always space for a Stressless®.



**Stressless® Wave SC 121** shown in Batick Snow / Black. **Stressless® Double** ottoman.



**Stressless® Pause SCA 11** shown in Paloma Black / Black. **Stressless® Oval** ottoman.

# Stressless® home cinema

Regardless of how much space you have available for your home cinema setup, our ingenious flexible modules ensure that there is always space for a Stressless®. Find your favourite model and then select your ideal arrangement from the size and positioning chart. The illustrations below show the most popular arrangements.



The Stressless® Sector (SC)/Sector Arm (SCA) is upholstered like the sofa and hides a storage space under its top. The Sector/Sector Arm also functions as an armrest, which is why setups with Sector/Sector Arm tables should be treated as a fixed unit.



The Ekornes® Corner table (CT) combines the need for a table with the need for individual positioning of the chairs and sofas. The Corner table is free-standing, allowing you to reorganise the furniture when needed.

### Sector (SC)

### Sector Arm (SCA)

### Corner table (CT)

Stressless® Pause		Stressless® Pause		Stressless® Pause	
	SC 11, W:184		SCA 11, W:208		CT 11, W:236
	SC 12, W:238		SCA 12, W:259		CT 12, W:287
	SC 111, W:275		SCA 111, W:294		CT 111, W:351
	SC 22, W:292		SCA 22, W:316		CT 22, W:338
	SC 121, W:330		SCA 121, W:349		CT 121, W:406
Stressless® Wave		Stressless® Wave		Stressless® Wave	
	SC 11, W:186		SCA 11, W:208		CT 11, W:236
	SC 12, W:240		SCA 12, W:259		CT 12, W:288
	SC 111, W:275		SCA 111, W:294		CT 111, W:348
	SC 22, W:294		SCA 22, W:316		CT 22, W:340
	SC 121, W:330		SCA 121, W:349		CT 121, W:403





Stressless® Wave SC 11 shown in Batick Snow / Black. Stressless® Oval ottoman.



The Stressless® Double ottoman features ample leg room for two, plus a storage space inside. It also comes with an optional wooden tabletop, which can be placed on the ottoman to provide a handy table when needed.

The Stressless® Oval ottoman has been built around the same general idea – with its removable pillow, it also acts as a convenient table. The pillow can be stored beneath the tabletop when not in use.



The smart Sector tables and armrests complete the Stressless® Home Cinema setup – both functionally and aesthetically. Now there's no need to get up – everyone can keep their own giant bowl of popcorn or selected beverage within reach! The armrests also double as practical storage spaces in the same way as the Stressless® ottomans.





# Comfort on wheels

---

Our line of Stressless® Home Office chairs provides the ultimate solution to a truly outstanding home office experience. Your back deserves the same comfort while working as it does while relaxing – and the simple truth is that if your back is comfortable, you can work better. With the combination of comfort and mobility, the Stressless® Home Office chair provides the perfect seat – ensuring that at the end of the day, all your hard work has been completed in comfort.

Stressless® Home Office chairs feature all the comfortable functionality of our recliners, including the Plus™ system, which offers synchronised neck and lumbar support adjustments. The seat's height can also be easily adjusted using the handle under the seat – to give you optimal comfort and superior freedom of movement.



**Stressless® Paris Office** shown in Cori Beige.

**Stressless® Wing Office** shown in Paloma Black.



**Stressless® Live Office** shown in Paloma Copper.

◀ **Stressless® London Office Low Back** shown in Cori Vanilla.





46/47

# Discover the secrets of personal comfort

The unique cushioning of our Stressless® recliners and sofas embraces and supports your body like nothing else, and 45 years of innovation has brought us to a point where we can wholeheartedly say that our Stressless® recliners and sofas are the best on the market. One of the reasons we can make such a bold claim is that the manufacturing of each and every Stressless® component takes place right here, by the fjords of Norway.



## Worth a test

Only you know what feels most comfortable for you, which is why we encourage all our customers to try a Stressless® – to ensure that you find a recliner with the right size and feel. Comfort is largely about choice, and regardless of which base you choose we guarantee you the same exceptional level of comfort. Try one of our recliners – we guarantee it will be time well spent. After all, a genuine Stressless® is an investment which you'll enjoy for many years to come.



Plus™-system



1. The perforated foam, moulded directly over the frame, gives you improved seating comfort since the indentations allow you to sink deeper into the seat and back of the recliner. Comfort Zones™ (patent pending) provide the proper contours for your body, offer good ventilation and guarantee that the cushions will remain long-lasting and comfortable.
2. A soft polyurethane foam pad ensures optimum softness.
3. The soft polyurethane foam pad is covered with a layer of super-soft polyester fibre for a real touch of luxury.
4. Flexo springs on a steel frame ensure durable construction and strength.
5. The Plus™ system automatically provides the correct support for your head and lower back. The function is double-sided for maximum stability, functionality and lifetime use.
6. Only genuine top-grain leather cover the front and back of Stressless® chairs.
7. The Stressless® glide system automatically adjusts to your body weight, with no buttons or levers to pull.
8. The various bases provide full stability and allow you to turn a full 360 degrees.
9. Laminated beech base. All colours are stained and varnished.



**BalanceAdapt™**



**Plus™-system**



- Can you adjust the headrest so that it lies flat when you recline?
- Is your head supported comfortably as you lie down to read or watch TV?
- Do you have the feeling that the seat back reclines sufficiently?
- Does the chair provide good lumbar support in all positions?
- Does the recliner feel stable and safe?
- Does the gliding movement smoothly adjust to your body weight?
- Do the chair and ottoman move with you as you shift position?
- Are the height and width of the chair right for you?
- Are you aware of your entire body relaxing?
- Is the ottoman positioned in the right place to give you maximum leg support?



Plus™-system



### Plus™ system

Perfect support and comfort regardless of whether you sit up straight or lean back. This isn't always easy to achieve, but our unique Plus™ system manages to ensure exactly that. The provided neck and lumbar support adjusts as you move – perfect for watching the television. If the film however doesn't live up to expectations, you can always activate the headrest's sleep function with a single easy movement and enjoy a snooze.



1. The patented Stressless® Plus™ system automatically adjusts the headrest as you recline – supporting your neck while you read, watch TV and rest.
2. Anatomically correct lumbar support in all positions – synchronises with the neck support function as part of the Stressless® Plus™ system.
3. The sleep function is activated with one simple movement to lay the headrest flat.
4. For unbeatable comfort, set the Stressless® wheel once and change your sitting position by using your body weight.



BalanceAdapt™



### BalanceAdapt™ system

The smallest of movements is often what makes the difference between a good sitting experience and a great one. With BalanceAdapt™, the sitting angle automatically adjusts to your body's every movement. It's all about finding the right balance – from head-to-toe, without the use of levers or handles. The subtle and soft rocking motion increases your comfort in any position and ensures that the sitting angle adjusts even further. The new headrest for Stressless® Panorama can be easily mounted without tools. The recliner also features the Plus™ system, which provides optimal support for your neck and lower back to give you a unique comfort experience.







**ErgoAdapt™**



## ErgoAdapt™ system

The built-in ErgoAdapt™ system of the Stressless® E600 allows you to sink into the soft cushions. This discreet tilting mechanism enables the sofa to automatically adjust to your body, providing you with a perfect sitting angle or sleeping position.

Our flexible headrest has subtle movement and is easily adjusted for a further improved sitting experience. The headrest can be mounted without tools. The Long Seat has its own specially adapted headrest with the same innovative functions.



### From zero position to tilt position

The Stressless® ErgoAdapt™ system automatically tilts the seat as you sit down – providing the perfect degree of comfort and support.



### Lying down flat, no tilt

When you lie down on the sofa the seat stays completely flat, offering exquisite comfort and enabling you to take full advantage of the oversized seat.



The Long Seat automatically tilts down to give your legs perfect support when seated, but stays completely flat when you lie down.

## Put your Stressless® E600 together exactly the way you want

No matter how limited your space may be, with our ingenious flexible modules there's always space for a Stressless®. First find your favourite model and then select your ideal arrangement. A few possible configurations in a variety of our styles are shown below.

### Standard sofas

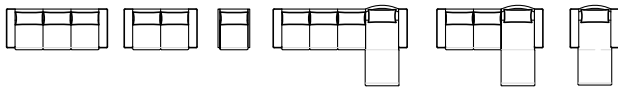

### Samples

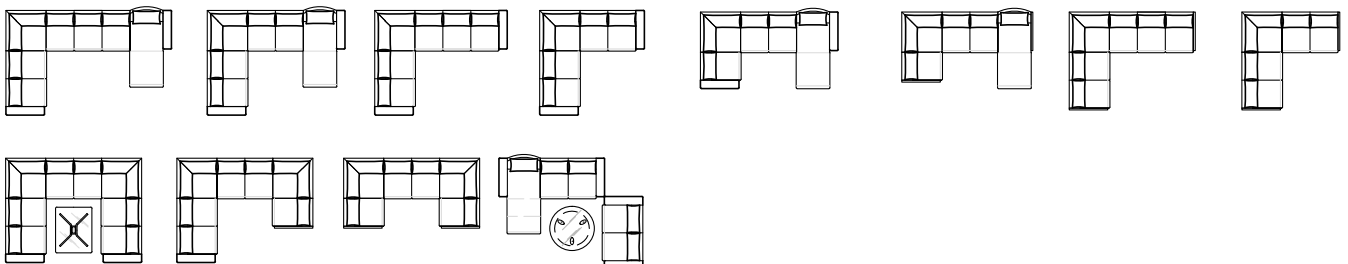

# Tables and ottomans

All of our tables are developed with functional design and their purpose in mind. Some are designed to fulfil the unique Stressless® comfort experience, and others to complement a specific Stressless® sofa model.



### STRESSLESS® ENIGMA

A stylish glass table with an aluminium base.  
Available in size W: 90 H: 44



### STRESSLESS® STYLE

An elegant sofa table and side table available in several colour combinations. The slight difference in height means that the tables can be easily combined in different ways, either apart from each other or close together. The tabletop is MDF with a melamine surface, available in White, Black and Cream. The wooden legs are available in Black, Natural and Brown. L: 137 D: 60 H: 47 / W: 55 H: 52



### STRESSLESS® FLEXI TABLE

Exclusively designed in stainless steel and glass, this table is height-adjustable. The glass plate can be easily tilted to create a standing laptop table. W: 54 D: 43 H: 55-70 (height-adjustable)



### STRESSLESS® ELLIPSE TABLE

This flexible, easy-to-move table is ideal, since it keeps everything you need within easy reach while you are in your "comfort zone".  
W: 49 D: 38 H: 54-74 (height-adjustable)



### EKORNES® CORNER TABLE

This practical table is specially designed for home cinema arrangements, but is also suitable for any corner setup.  
W: 69 D: 60 H: 48



### STRESSLESS® DUO TABLE

Made from high-quality toughened glass and beech. Available in Natural or stained in the following colours: Oak, Walnut, Teak, Brown, Wenge and Black. Add up to four Stressless® Duo ottomans and the result is the epitome of functional design. W: 108 D: 86 H: 44

### STRESSLESS® DUO OTTOMAN

Can be used as a footstool or as a small table. Simply take the wooden tabletop from the side, place it on top of the ottoman, and you have a convenient, small and movable table. When not in use, you can easily place the ottoman under the Stressless® Duo table. W: 61 D: 34 H: 44



### STRESSLESS® OTELO

A solid stool, available with either an aluminium or moulded beech base.  
W: 100 D: 50 H: 45



### STRESSLESS® OVAL OTTOMAN

The Stressless® oval ottoman has a removable cushion, so it doubles as a convenient table. When you don't need to put your feet up, simply store the cushion below the tabletop.  
W: 90 D: 48 H: 47







**STRESSLESS® URBAN TABLE**

The stylish Stressless® Urban glass table is designed to match the new Stressless® Metro and City recliners. Choose from a large sofa table or a practical smaller version to place next to your Stressless® recliner. W: 90 H: 48 / W: 55 H: 48

**STRESSLESS® COFFEE TABLE**

A flexible and cleverly designed table in stainless steel and glass, which perfectly fits above the seat of your sofa. Your snack or beverage will never be more than arm's length away. The Stressless® Coffee table can also be used as a side table, and if you put two of them together they form an ingenious sofa table. W: 60 D: 50 H: 50



**EKORNES® PEGASUS TABLE**

Made from beech. Available in Natural or stained in the following colours: Oak, Walnut, Teak, Brown, Wenge and Black. W: 127 D: 77 H: 48



**EKORNES® WINDSOR TABLE**

Made from beech. Available in Natural or stained in the following colours: Oak, Walnut, Teak, Brown, Wenge and Black. W: 132 D: 70 H: 48



**STRESSLESS® EASY ARMREST TABLE**

This smart idea has been designed for the Stressless® Arion and Stressless® E200. Simply place the table on the armrest for a convenient extra surface. W: 25 D: 23 H: 10



**STRESSLESS® SWING TABLE**

The table remains independent of your movements and can be simply swung aside when not in use. W: 28



**STRESSLESS® COMPUTER TABLE**

The table provides a good working position and remains independent of your movements. Simply swing to the side and fold down when not in use. W: 41 D: 31



**STRESSLESS® DOUBLE OTTOMAN**

The large ottoman offers ample space to put your feet up, while the storage space hides a tabletop that can be placed on the ottoman when needed. W: 119/154 D: 61 H: 44



W: 51 D: 40 H: 44

W: 60 D: 60 H: 44

W: 53 D: 49 H: 44

W: 64 D: 70 H: 44

**STRESSLESS® MODERN AND STRESSLESS® SOFT OTTOMAN**

Our ottoman is ingenious in at least two ways. Firstly, it features a built-in tilt system, which ensures that the angle of the ottoman adjusts to your sitting position. Secondly, it has room for all your extras under its removable top. Available in two sizes.



52/53



Classic



Plus<sup>®</sup>-system

**STRESSLESS<sup>®</sup> CAPRI**



Stressless<sup>®</sup> Capri (S)  
Chair, W: 77 H: 100/110 D: 76  
Seat height: 45

Stressless<sup>®</sup> Capri (M)  
Chair, W: 81 H: 102/112 D: 82  
Seat height: 46

Stressless<sup>®</sup> Capri (L)  
Chair, W: 90 H: 102/112 D: 82  
Seat height: 48

Stool, W: 57 H: 44 D: 50

**STRESSLESS<sup>®</sup> CROWN**



Stressless<sup>®</sup> Crown (S)  
Chair, W: 71 H: 96 D: 75  
Seat height: 40

Stressless<sup>®</sup> Crown (M)  
Chair, W: 75 H: 98 D: 75  
Seat height: 42

Stressless<sup>®</sup> Crown (L)  
Chair, W: 84 H: 102 D: 79  
Seat height: 43

Stool, W: 54 H: 40 D: 41

**STRESSLESS<sup>®</sup> GARDA**



Stressless<sup>®</sup> Garda (S)  
Chair, W: 72 H: 94 D: 70  
Seat height: 38

Stressless<sup>®</sup> Garda (M)  
Chair, W: 76 H: 100 D: 71  
Seat height: 40

Stressless<sup>®</sup> Garda (L)  
Chair, W: 85 H: 100 D: 77  
Seat height: 42

Stool, W: 54 H: 38 D: 39

**STRESSLESS<sup>®</sup> LIVE**



Stressless<sup>®</sup> Live (S)  
Chair, W: 77 H: 99 D: 76  
Seat height: 41

Stressless<sup>®</sup> Live (M)  
Chair, W: 81 H: 103 D: 76  
Seat height: 42

Stressless<sup>®</sup> Live (L)  
Chair, W: 90 H: 103 D: 78  
Seat height: 45

Stool, W: 57 H: 39 D: 40



Signature



Plus<sup>®</sup>-system



BalanceAdapt<sup>™</sup>



Stressless<sup>®</sup> Capri (S)  
Chair, W: 78 H: 103/113 D: 76  
Seat height: 48

Stressless<sup>®</sup> Capri (M)  
Chair, W: 82 H: 104/114 D: 82  
Seat height: 48

Stressless<sup>®</sup> Capri (L)  
Chair, W: 91 H: 104/114 D: 82  
Seat height: 49

Stool, W: 57 H: 47 D: 50



Stressless<sup>®</sup> Crown (S)  
Chair, W: 80 H: 99 D: 75  
Seat height: 43

Stressless<sup>®</sup> Crown (M)  
Chair, W: 84 H: 100 D: 76  
Seat height: 44

Stressless<sup>®</sup> Crown (L)  
Chair, W: 93 H: 104 D: 82  
Seat height: 45

Stool, W: 54 H: 43 D: 41



Stressless<sup>®</sup> Garda (S)  
Chair, W: 78 H: 97 D: 70  
Seat height: 41

Stressless<sup>®</sup> Garda (M)  
Chair, W: 82 H: 102 D: 72  
Seat height: 42

Stressless<sup>®</sup> Garda (L)  
Chair, W: 91 H: 102 D: 79  
Seat height: 44

Stool, W: 54 H: 41 D: 39



Stressless<sup>®</sup> Live (S)  
Chair, W: 79 H: 102 D: 76  
Seat height: 44

Stressless<sup>®</sup> Live (M)  
Chair, W: 83 H: 105 D: 76  
Seat height: 44

Stressless<sup>®</sup> Live (L)  
Chair, W: 92 H: 105 D: 81  
Seat height: 46

Stool, W: 57 H: 42 D: 44



Office



Plus<sup>®</sup>-system



Stressless<sup>®</sup> Capri Office (M)  
Chair, W: 81 H: 110/117 D: 79  
Seat height: 53/60



Stressless<sup>®</sup> Crown Office (M)  
Chair, W: 75 H: 107/114 D: 73  
Seat height: 51/58



Stressless<sup>®</sup> Garda Office (M)  
Chair, W: 75 H: 112/119 D: 71  
Seat height: 47/54



Stressless<sup>®</sup> Live Office (M)  
Chair, W: 81 H: 113/120 D: 72  
Seat height: 49/56



**Hard Floor Protector**

Self-adhesive felt for use under the base as floor protection. For Classic base.



**Classic elevator ring**

The Stressless<sup>®</sup> elevator ring adds an extra 3,5 cm to the seat height, and is your key to comfort if you require extra height. Simply snap it on: no tools necessary.

The Stressless<sup>®</sup> footstool elevator ring adds 3,5 cm to the footstool's height. Fits all footstools produced after 1 March 2004.



**STRESSLESS® NORDIC**

Stressless® Nordic (S)  
Chair, W: 71 H: 98 D: 73  
Seat height: 40

Stressless® Nordic (M)  
Chair, W: 75 H: 100 D: 75  
Seat height: 42

Stressless® Nordic (L)  
Chair, W: 84 H: 101 D: 78  
Seat height: 45

Stool, W: 54 H: 40 D: 41

**STRESSLESS® PEACE**

Stressless® Peace (S)  
Chair, W: 77 H: 98 D: 73  
Seat height: 40

Stressless® Peace (M)  
Chair, W: 81 H: 100 D: 75  
Seat height: 42

Stressless® Peace (L)  
Chair, W: 90 H: 101 D: 78  
Seat height: 45

Stool, W: 54 H: 40 D: 41

**STRESSLESS® PRESIDENT**

Stressless® President (S)  
Chair, W: 77 H: 96 D: 71  
Seat height: 39

Stressless® President (M)  
Chair, W: 81 H: 99 D: 73  
Seat height: 41

Stressless® President (L)  
Chair, W: 90 H: 100 D: 76  
Seat height: 44

Stool, W: 54 H: 38 D: 38

**STRESSLESS® VIVA**

Stressless® Viva (S)  
Chair, W: 77 H: 96/105 D: 77  
Seat height: 42

Stressless® Viva (M)  
Chair, W: 81 H: 97/107 D: 78  
Seat height: 44

Stressless® Viva (L)  
Chair, W: 90 H: 100/110 D: 78  
Seat height: 45

Stool, W: 54 H: 39 D: 37

**STRESSLESS® WING**

Stressless® Wing (S)  
Chair, W: 71 H: 96 D: 71  
Seat height: 40

Stressless® Wing (M)  
Chair, W: 75 H: 101 D: 71  
Seat height: 42

Stressless® Wing (L)  
Chair, W: 81 H: 102 D: 76  
Seat height: 44

Stool, W: 54 H: 38 D: 38



Stressless® Nordic (S)  
Chair, W: 80 H: 101 D: 73  
Seat height: 43

Stressless® Nordic (M)  
Chair, W: 84 H: 102 D: 76  
Seat height: 44

Stressless® Nordic (L)  
Chair, W: 93 H: 103 D: 80  
Seat height: 47

Stool, W: 54 H: 43 D: 41



Stressless® Peace (S)  
Chair, W: 80 H: 101 D: 73  
Seat height: 43

Stressless® Peace (M)  
Chair, W: 84 H: 102 D: 76  
Seat height: 44

Stressless® Peace (L)  
Chair, W: 93 H: 103 D: 78  
Seat height: 47

Stool, W: 54 H: 43 D: 41



Stressless® President (S)  
Chair, W: 78 H: 99 D: 71  
Seat height: 42

Stressless® President (M)  
Chair, W: 82 H: 100 D: 74  
Seat height: 43

Stressless® President (L)  
Chair, W: 91 H: 102 D: 78  
Seat height: 46

Stool, W: 54 H: 41 D: 38



Stressless® Viva (S)  
Chair, W: 77 H: 99/109 D: 77  
Seat height: 45

Stressless® Viva (M)  
Chair, W: 81 H: 99/109 D: 78  
Seat height: 45

Stressless® Viva (L)  
Chair, W: 90 H: 102/112 D: 79  
Seat height: 47

Stool, W: 54 H: 42 D: 37



Stressless® Wing (S)  
Chair, W: 80 H: 99 D: 71  
Seat height: 43

Stressless® Wing (M)  
Chair, W: 84 H: 103 D: 72  
Seat height: 44

Stressless® Wing (L)  
Chair, W: 93 H: 104 D: 78  
Seat height: 45

Stool, W: 54 H: 41 D: 38



Stressless® Nordic Office (M)  
Chair, W: 75 H: 108/115 D: 72  
Seat height: 50/57



Stressless® Peace Office (M)  
Chair, W: 81 H: 108/115 D: 72  
Seat height: 50/57



Stressless® President Office (M)  
Chair, W: 81 H: 108/115 D: 69  
Seat height: 50/57



Stressless® Viva Office (M)  
Chair, W: 82 H: 106/113 D: 73  
Seat height: 50/57



Stressless® Wing Office (M)  
Chair, W: 75 H: 111/118 D: 72  
Seat height: 47/54

**Signature elevator-kit**

If you require additional height on your Stressless® with a Signature base you can order an elevator kit, which is easily attached and will increase the height of your chair by 3 cm.



Adjustable headrest.



**Stressless® Paris Low Back**  
Chair, W: 80 H:87/91 D:70  
Seat height: 43/47



**Stressless® Paris**  
Chair, W: 80 H:110/115 D:71  
Seat height: 43/47  
Stool, W: 54 H: 42/46 D: 41



**Stressless® Paris Office Low Back**  
Chair, W: 80 H:97/104 D:69  
Seat height: 43/50



**Stressless® Paris Office**  
Chair, W: 80 H:121/128 D:70  
Seat height: 43/50



**Stressless® London Low Back**  
Chair, W: 80 H:87/91 D:70  
Seat height: 43/47



**Stressless® London**  
Chair, W: 80 H:112/116 D:71  
Seat height: 43/47  
Stool, W: 54 H: 42/46 D: 41



**Stressless® London Office Low Back**  
Chair, W: 80 H:97/104 D:69  
Seat height: 43/50



**Stressless® London Office**  
Chair, W: 80 H:122/129 D:70  
Seat height: 43/50

Stressless® London and Stressless® Paris can be ordered in two seat heights, 43 cm (standard) and 47 cm (tall). Please specify preferred seat height when ordering through your retailer (applies to both high and low back editions).

Medium Corner:  
**Stressless® Pause**  
MC 23, W: 297 MC 22, W: 242

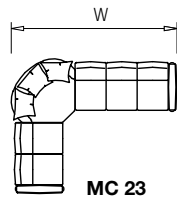

**MC 23**

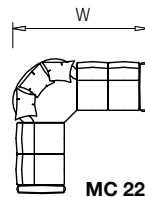

**MC 22**



Medium Corner,  
W: 137 H: 74 D: 116  
Seat height: 44

**Stressless® Wave**  
MC 23, W: 298 MC 22, W: 243

Big Corner:  
**Stressless® Como**

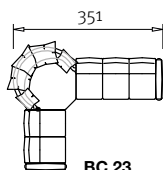

**BC 23**

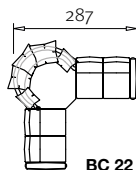

**BC 22**



Big Corner,  
W: 140 H: 79 D: 132  
Seat height: 44



## Stressless® Como (L)

Low back



Plus<sup>®</sup>-system

High back



**2 seater**

W: 182 H: 86 D: 89  
Seat height: 46



**3 seater**

W: 246 H: 86 D: 89  
Seat height: 46

**Matching  
Recliner:**  
Stressless® Capri



**2 seater**

W: 182 H: 102/112 D: 89  
Seat height: 46



**3 seater**

W: 246 H: 102/112 D: 89  
Seat height: 46

**Ottoman:**  
Soft Ottoman (M)  
Soft Ottoman (L)

## Stressless® Pause (M)

Low back



Plus<sup>®</sup>-system

High back



**Chair**

W: 88 H: 84 D: 87  
Seat height: 44



**2 seater**

W: 143 H: 84 D: 87  
Seat height: 44



**3 seater**

W: 198 H: 84 D: 87  
Seat height: 44

**Matching  
Recliner:**  
Stressless® Peace



**Chair**

W: 88 H: 97/107 D: 87  
Seat height: 44



**2 seater**

W: 143 H: 97/107 D: 87  
Seat height: 44



**3 seater**

W: 198 H: 97/107 D: 87  
Seat height: 44

**Ottoman:**  
Modern Ottoman (M)  
Modern Ottoman (L)

## Stressless® Wave (M)

Low back



Plus<sup>®</sup>-system

High back



**Chair**

W: 91 H: 84 D: 81  
Seat height: 44



**2 seater**

W: 146 H: 84 D: 81  
Seat height: 44



**3 seater**

W: 201 H: 84 D: 81  
Seat height: 44

**Matching  
Recliner:**  
Stressless® Nordic



**Chair**

W: 91 H: 101 D: 81  
Seat height: 44



**2 seater**

W: 146 H: 101 D: 81  
Seat height: 44



**3 seater**

B: 201 H: 101 D: 81  
Seat height: 44

**Ottoman:**  
Modern Ottoman (M)  
Modern Ottoman (L)

## Stressless® Panorama (M)



BalanceAdapt™



**2 seater**  
W: 159 H: 83 D: 85  
Seat height: 44



**3 seater**  
W: 217 H: 83 D: 85  
Seat height: 44

**Matching Recliner:**  
Stressless® Nordic  
Stressless® Paris

**Ottoman:**  
Modern Ottoman (M)  
Modern Ottoman (L)

## Stressless® E600



BalanceAdapt™



**1 seater**  
W:75 H:85 D:96  
Seat height 46



**2 seater**  
W:172 H:85 D:96  
Seat height 46



**3 seater**  
W:238 H:85 D:96  
Seat height 46



**Long Seat**  
W:116 H:85 D:188  
Seat height 46



**2 seater with Long Seat**  
W:250 H:85 D:188  
Seat height 46



**c 32/23**  
W:313 H:85 D:247  
Seat height 46

## Ekornes® Manhattan



**Chair**  
W: 103 H: 79 D: 91  
Seat height: 44



**2 seater**  
W: 161 H: 79 D: 91  
Seat height: 44



**3 seater**  
W: 219 H: 79 D: 91  
Seat height: 44

**Matching Recliner:**  
Stressless® Live

**Ottoman:**  
Soft Ottoman (M)  
Soft Ottoman (L)

## Ekornes® Oslo



**3 seater**  
W: 172 H: 82 D: 92  
Seat height: 47



**4 seater**  
W: 217 H: 82 D: 92  
Seat height: 47

**Matching Recliner:**  
Stressless® Live

**Ottoman:**  
Soft Ottoman (M)  
Soft Ottoman (L)



# Stressless® legs

---

Our sofa models can be delivered with different legs. Steel legs provide your sofa with a more sophisticated appearance, whilst wooden legs make your living room appear warmer. No matter what your style and choice, with Stressless® comfort is a guarantee.



**Steel leg**  
E600/Wave/  
Pause/Como  
Sector/Sector Arm  
Medium Corner  
Big Corner



**Wooden leg**  
E600/Wave/  
Pause/Como  
Sector/Sector Arm  
Medium Corner



**Wooden leg**  
Medium Corner



**Steel hoop**  
Wave



**Wooden hoop**  
Wave



**Wooden hoop**  
Panorama

The round legs are available in three heights:  
80/110/140 mm

# The Stressless® wood colours

---

Ekornes uses rotary cut beech veneer in all its moulded furniture components. For solid wood components, lightly steamed beech is used. The hardness of the wood makes beech furniture extremely durable, and the timber we use is a renewable resource. Beech is a natural material, and variations in its pattern, colour and texture make each piece of furniture unique. Even though beech is used in both the solid and moulded components, structural differences may be visible.



Natural Oak Walnut Teak Brown Wenge Black

# Stressless® Leather Care kits

---

To match the high quality of our furniture, Ekornes offers its own leather care series. The Stressless® Leather Care kit (medium, large) and the Stressless® Leather Care Wipes contain a leather cleaner, a protection cream and wipes. For nurturing, and making the leather more resistant to stains, the protection cream should be applied to all leather surfaces when your recliner is new. For later treatment, in addition to regularly removing stains, we recommend that the leather is cleaned with the Stressless® Leather Cleaner at least every 6 months. Always apply protection cream after cleaning.

These are the only cleaning products recommended by Ekornes. Ekornes accepts no responsibility in cases where cleaning products other than those recommended by Ekornes have been used and damaged the leather.





# Ekornes® offers four categories of leather, in a selection of beautiful colours.

## Batick

**BATICK** is a corrected, pigment-improved and grain-embossed upholstery leather, which has had most of its natural marks removed. Batick may have a two-tone colour effect to liven up the surface. Batick is resistant to fading, although changes in colour will occur over time due to use and exposure to light. A protective layer of lacquer simplifies cleaning. Simple cleaning, excellent utilisation properties and a favourable price make Batick a good choice.

**CORI** is a corrected, pigment-improved and grain-embossed upholstery leather. Cori is somewhat thicker, and has a larger pebbled grain, than Batick. Most of its natural marks are removed. Also, some of the Cori colours have a two-tone colour effect to liven up the surface. A protective layer of lacquer simplifies cleaning. Cori is a wise choice if you want leather with excellent utilisation properties and a robust structure.

**PALOMA** is a slightly corrected leather with a combination of dyes and pigments that smoothes down some of the structure (the grain pattern) of the leather. The grain structure in Paloma may, however, vary a little at some parts of the furniture and also minor colour nuances may appear in the leather. Natural marks, scars and insect bites are natural and will appear in Paloma. A thin coat of lacquer gives Paloma some protection and simplifies cleaning, but Paloma does not have the same heavy-duty quality and protection as Batick and Cori. Due to its soft, natural and comfortable expression, Paloma is a very popular choice.

**NOBLESSE** is the most exclusive leather in Ekornes' collection. It is a full grain, semi-aniline leather, which means that the leather is dyed using a light surface treatment. This provides a certain amount of protection, while maintaining the natural softness and glow that are characteristic of a first class upholstery leather. A natural material such as Noblesse retains its original grain and structure, and various grain patterns may be visible at different areas of the furniture. Minor colour variations and marks resulting from scars and injuries may also be visible, and are characteristic of a natural material like Noblesse. Due to the light surface treatment, Noblesse is the most delicate of Ekornes' leathers. It easily absorbs moisture and is extra sensitive to wear, heat, exposure to sunlight, stains and sweat. Regular maintenance is important in order to maintain the leather's exceptional appearance.

## Cori

## Ekornes® upholstery leather

Ekornes is one of Europe's largest consumers of leather. We purchase the leather from selected tanneries all over the world. Our own inspectors take part in the leather selection, which is conducted in accordance with international norms for quality determination. The experience we have gained from this work is for your benefit when you buy Stressless® or Ekornes® leather furniture. Our leather is manufactured according to current laws, guidelines and recommendations relating to their utilisation properties, and for the use and content of chemicals and other substances. We are cooperating with recognised international institutions in this line of business, to ensure that we are updated at all times with events relating to health, safety and the environment.

### The leather for our furniture is a natural material that comes from cattle hides

When the hide has gone through a tanning process and further processing to achieve the correct utilisation properties, it is called leather. One characteristic of hide is that it is marked by nature, vegetation and the care the animal has been subjected to. Cattle spend most of their lives outdoors, and will therefore be marked by external influences like insect bites, tears, scars, wrinkles, stretch marks, etc.

### The following are some of the properties of leather that you should be aware of

Leather is a natural product and is a beautiful and lively material used in furniture-making. Each hide is unique in its structure, appearance, nuance and size.

Ekornes may use several hides when making your furniture. This, together with the leather's play of colours and natural marks, makes each piece of furniture unique. In time, the leather will age and gain patina. It is important that you are aware of one thing: although leather furniture can withstand a lot of wear and tear, its appearance will change with the years.

The following applies to all types of leather used by Ekornes: Hide absorbs dyes differently, and therefore the leather may have colour nuances. These are due to dissimilarities and different fibre structures, which affect the colouring of the hide and how the hide absorbs the dyes during the tanning process.

All our leather qualities are deep-dyed, but there could always be a deviation between the basic colour of the hide (the colour of the side that faces the upholstery side of the furniture), and the colour of the grain side (the external side): i.e. the colour of the outer layer. This is normal. It is possible to use the same basic colour for leathers with different top colours.

Dyes and dyeing methods may vary between the different leather colours and leather qualities. Therefore, the basic colour and the colour of the top layer (which forms the wear layer and the final desired colour of the finished product) of a given leather quality may differ.

Some of the leather dyes have a two-tone colour effect (shadow/ antique effect). Leather dyed with a two-tone effect may change character faster and wear more unevenly than leather with just one colour. This applies in particular to areas of the furniture that are exposed to harder wear such as armrests, seat cushions and neck supports.

The top layer protects the leather and simplifies cleaning, but is nonetheless vulnerable to soiling and wear. If the top layer/top colour is destroyed, the leather may deteriorate faster. Penetrating spills/damage/scratches are normally irreparable and may result in the top colour changing character, cracking or peeling off.

Denim clothes and hard textiles, such as dungaree jeans, expose the leather to strong wear and may leave colour on the leather which is difficult to remove, without risking destruction of the top colour of the leather. Light leather colours in particular are vulnerable to such colour contamination.

All furniture leather sold by Ekornes is resistant to light, but changes in colour may occur as a result of use and extensive exposure to light. Consequently, furniture should not be exposed to direct sunlight or direct heat from heaters and other sources of heat. Leather is vulnerable to exposure to oils from direct contact with human skin (especially of the neck and hands).

Remember: leather has a relatively long life-time, but can easily be destroyed by incorrect handling.

## Paloma

## Noblesse





STRESSLESS® GARDA

S M L

**Stressless® Garda (M) Classic** recliner shown in Paloma Sand / Wenge. **Stressless® Flexi** table.

Read more about our base options on pages 6-7.



NB: Ekornes products are under constant development, and we therefore disclaim any liabilities due to products that may differ from product images in the catalogue, as well as possible typing errors and colour differences in the catalogue.



## EKORNES® AND THE ENVIRONMENT

The objective of Ekornes is to accept environmental responsibility related to manufacturing, distribution and use of the company's products.

We will continue to implement initiatives in our factories that improve the internal and external environment, at the same time as we continue to select environmentally-friendly raw materials.

A sustainable manufacture of durable products will also in future be an objective in the development of our company.

The following core items shall be complied with in all parts of our activity:

- Ekornes shall appear as an environmentally-friendly enterprise. Our products shall cause the least possible impact on the environment.
- Ekornes has as its objective to keep the health risk at the workplaces at a minimum.
- Ekornes invests to avoid damage to the environment and injuries to health.
- Environmental information shall be generally available, for example through Environmental Product Declarations (EPD).
- Ekornes shall give objective and open information about how the company handles its environmental responsibility.

Ekornes has as its long-term objective to develop environmental issues to a competitive advantage through being ahead of our competitors also in this field.

Ekornes participates in the UN's Global compact.



Stressless® and Ekornes® are registered trademarks owned by Ekornes ASA, Norway.

# EKORNES®

[www.ekornes.co.uk](http://www.ekornes.co.uk)

Retailer: